



COPENHAGEN PENDANT SC6
(OPAL GLASS)

BY SPACE COPENHAGEN
2017



COPENHAGEN PENDANT SC6 (OPAL GLASS)

BY SPACE COPENHAGEN
2017

“Our ambition was to design a pendant with a simple industrial feel, but which was still elegant and poetic.”

The Copenhagen Pendant is an exercise in contrasts. Combining the classic and the modern, the maritime and the industrial, it is a new pendant developed by Space Copenhagen for &tradition. Following the success of their first collaboration, the Fly Lounge Series, &tradition have worked with Space Copenhagen again to produce a pendant range in matt lacquered metal, one of Space Copenhagen's first lights to enter production.

The Copenhagen Pendant evokes memories of maritime gas lamps silhouetted against a striking nordic sky. With this new addition to the series in matt opal, designers Signe Bindslev Henriksen and Peter Bundgaard Rützou from Space Copenhagen are enhancing the ambient light and the poetic aesthetic appeal.

“We really love the softness of this satinised matt opal glass in combination with the darkened brass,” says Henriksen. “It enhances the sculptural qualities of the shade in such a beautiful and poetic manner. At the same, the semi-transparent shade allows for ambient light for practically any space or occasion.”

For Rützou, a key factor for the lamp was their desire to create a soft, cosy atmosphere. “We live in a part of the world where we have long periods with very little light, so it's in our bones to seek, create and appreciate warm light that glows.”

Whether alone or clustered in a group with its siblings in black, white or lacquered pastels, the Copenhagen Pendant makes a modern statement that's nothing less than stunning. “It's a classic icon contemporised,” adds &tradition Brand Manager Martin Kornbek Hansen. “It merges the maritime with the industrial in an elegant expression that's utterly engaging.”



COPENHAGEN PENDANT SC6 (OPAL GLASS)

BY SPACE COPENHAGEN
2017

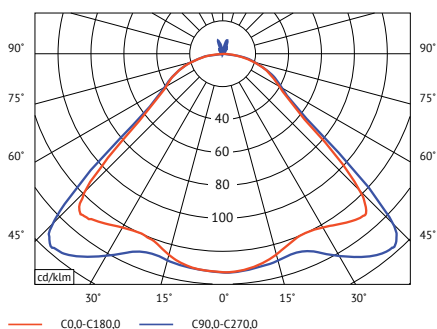
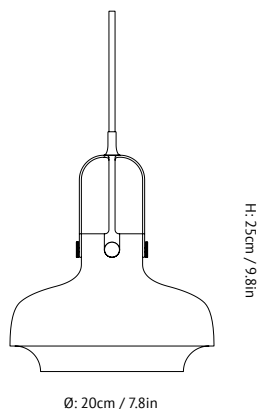

Photometric data file (LDT or IES) available upon request.

Product category	Pendant
Production Process	The shade is made from mouth-blown opal glass. The suspension is made from milled and laser cut bronzed brass.
Environment	Indoor
Material	Satinized opal glass shade, bronzed brass suspension, 4m black textile cord
Dimensions (cm/in)	Ø: 20cm/7.8in, H: 25cm/9.8in.
Weight (kg)	1.00kg
Colours	White satinized opal glass and bronzed brass
Light source & energy efficiency	G9 Max 40 Watt. The luminaire is compatible with bulbs of the energy classes: A++ - E. Bulb is not included.
Voltage	220-240V - 50Hz.
Certifications	CE, IP20, Class II
Canopy	Included
Cord length/diameter (cm/in)	400cm/157.5in.
Cleaning Instructions	Clean with soft dry cloth. Always switch off the electricity supply before cleaning.
Package Dimensions (cm/in)	H: 30cm/ 11.8in, W: 27cm/10.6in, D: 27cm/10.6in.

PRODUCT



COLOUR

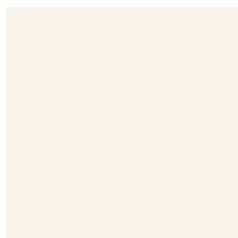

Opal glass



COPENHAGEN PENDANT SC7
(OPAL GLASS)

BY SPACE COPENHAGEN
2017



COPENHAGEN PENDANT SC7 (OPAL GLASS)

BY SPACE COPENHAGEN
2017

“Our ambition was to design a pendant with a simple industrial feel, but which was still elegant and poetic.”

The Copenhagen Pendant is an exercise in contrasts. Combining the classic and the modern, the maritime and the industrial, it is a new pendant developed by Space Copenhagen for &tradition. Following the success of their first collaboration, the Fly Lounge Series, &tradition have worked with Space Copenhagen again to produce a pendant range in matt lacquered metal, one of Space Copenhagen's first lights to enter production.

The Copenhagen Pendant evokes memories of maritime gas lamps silhouetted against a striking nordic sky. With this new addition to the series in matt opal, designers Signe Bindslev Henriksen and Peter Bundgaard Rützou from Space Copenhagen are enhancing the ambient light and the poetic aesthetic appeal.

“We really love the softness of this satinised matt opal glass in combination with the darkened brass,” says Henriksen. “It enhances the sculptural qualities of the shade in such a beautiful and poetic manner. At the same, the semi-transparent shade allows for ambient light for practically any space or occasion.”

For Rützou, a key factor for the lamp was their desire to create a soft, cosy atmosphere. “We live in a part of the world where we have long periods with very little light, so it's in our bones to seek, create and appreciate warm light that glows.”

Whether alone or clustered in a group with its siblings in black, white or lacquered pastels, the Copenhagen Pendant makes a modern statement that's nothing less than stunning. “It's a classic icon contemporised,” adds &tradition Brand Manager Martin Kornbek Hansen. “It merges the maritime with the industrial in an elegant expression that's utterly engaging.”



COPENHAGEN PENDANT SC7 (OPAL GLASS)

BY SPACE COPENHAGEN
2017

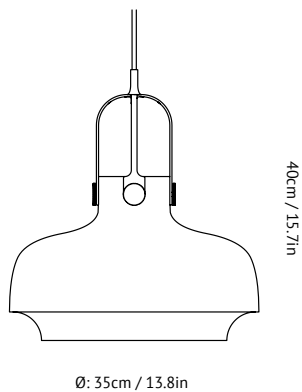

Ø: 35cm / 13.8in

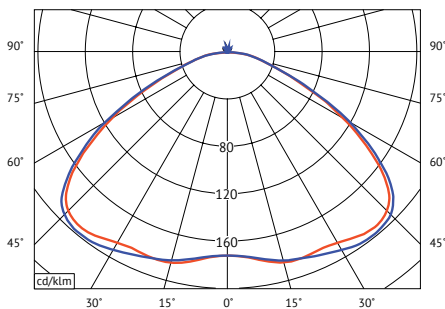

— C0,0-C180,0 — C90,0-C270,0

Product category	Pendant
Production Process	The shade is made from mouth-blown opal glass. The suspension is made from milled and laser cut bronzed brass.
Environment	Indoor
Material	Satinized opal glass shade, bronzed brass suspension, 4m black textile cord w. wire.
Dimensions (cm/in)	Ø: 35cm/13.8in, H: 40cm/15.7in.
Weight (kg)	3.5kg
Colours	White satinized opal glass and bronzed brass
Light source & energy efficiency	E27 Max 100 Watt. The luminaire is compatible with bulbs of the energy classes: A++ - E. Bulb is not included.
Voltage	220-240V - 50Hz.
Certifications	CE, IP20, Class II
Canopy	Included
Cord length/diameter (cm/in)	400cm/157.5in.
Cleaning Instructions	Clean with soft dry cloth. Always switch off the electricity supply before cleaning.
Package Dimensions (cm/in)	H: 46cm/18.1in, W: 42cm/16.5in, D: 42.0 cm/16.5in.

PRODUCT



COLOUR

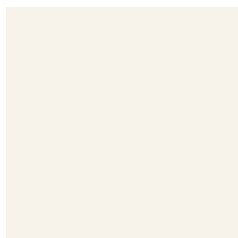

Opal glass



USER INSTRUCTIONS

COPENHAGEN PENDANT SC6

BY SPACE COPENHAGEN
2014

Congratulations on choosing this original Copenhagen Pendant SC6 lamp, designed in 2014 by Space Copenhagen. We hope you will enjoy using this product and follow these instructions to ensure correct installation. If you have any questions or comments, please do not hesitate to contact us by mail on:

info@andtradition.com

CONTENTS

- A - Opal glass shade
- B - 4 meter fabric cord fitted with ceiling loop and connector block
- C - Two-part ceiling cup

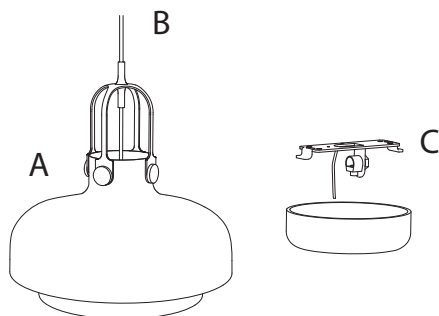

Please read these instructions carefully and retain them for future reference to ensure that the lamp is used correctly. For your own safety, please study each step of this instruction manual first. &tradition is not responsible for any faults or damages caused by not following these instructions correctly. Do not modify this lamp in any way.

TOOLS NEEDED

- Small flat-head screwdriver for wiring
- Cable cutters
- Cable stripper
- Bulb type: G9 max 40 Watt

SAFETY PRECAUTIONS

- Dispose of the bag from packaging and do not allow children to play with it.
- Keep product well out of children's reach.
- The lamp is only intended for interior use.
- Do not attempt installation of product if you are not competent to do so yourself.
- Consult a professionally qualified electrician if in any doubt.
- Disconnect the electricity supply at the fuse box, before commencing work.

CLEANING INSTRUCTIONS

- Wipe surface of the lamp shade with a soft dry cloth.
- Do not use any abrasive cleaning tools such as steel wool, scouring sponges or stiff brushes.
- Never use strong cleaning agents such as white spirit, turpentine, household glass cleaner or cellulose thinners.

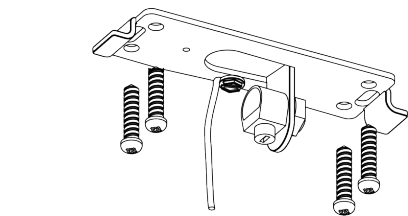

STEP 1

Ensure power supply is turned OFF and remove any existing lamp fitting. Locate the supply cable and ensure it is ready to be fitted to the connector block. Mount the metal plate securely in the ceiling with screws and appropriate wallplugs for the type of ceiling of the installation.

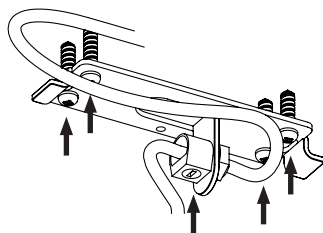

STEP 2

To determine the right hanging height for the lamp, pass the electrical cord through the strain relief of the metal plate, when the desired height of the lamp is defined, tighten the plastic screw of the strain relief.

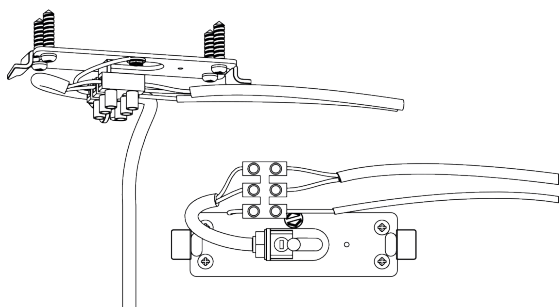

STEP 3

Connecting the wires:

Cut off the excess cord using a cable cutter so that a minimum of 80 mm cord is left to reconnect to the cable connector. Peel back the outer cable using a cable stripper to expose 30 mm of the blue and brown inner cables. Strip the inner cable to expose 5 mm of wire. Connect the blue supply wire to the blue fixture wire. Connect the brown supply wire to the brown fixture wire. Connect the green supply wire to the green fixture wire.

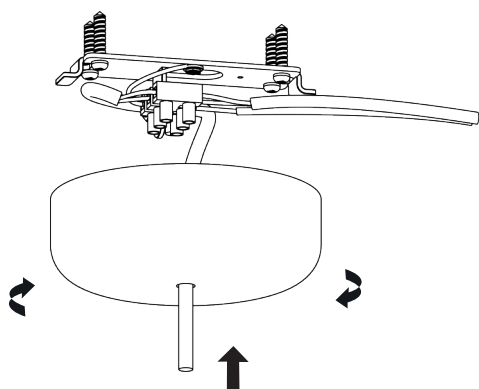

STEP 4

Install the plastic canopy onto the metal plate.

STEP 5

Bulb installation:

- Unscrew the small glass diffuser installed in the bulb socket.
- Install the G9 bulb onto the socket (when installing the bulb - make sure the bulb metal pins are not loose when inside the bulb socket. Also avoid touching the bulb with your fingers - use a dry cloth or a paper tissue).
- Screw the glass diffuser back onto the bulbsocket.

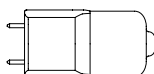
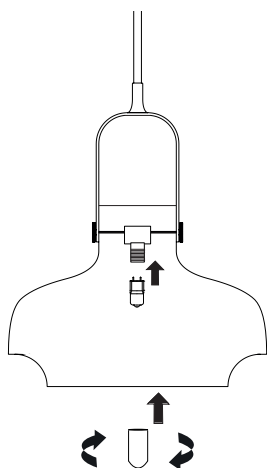

Maximum 40 W.
G9 bulb.

CE □ F IP20

& tradition®



USER INSTRUCTIONS

COPENHAGEN PENDANT SC7

BY SPACE COPENHAGEN
2014

Congratulations on choosing this original Copenhagen Pendant SC7 lamp, designed in 2014 by Space Copenhagen. We hope you will enjoy using this product and follow these instructions to ensure correct installation. If you have any questions or comments, please do not hesitate to contact us by mail on:

info@andtradition.com

CONTENTS

- A - Opal glass shade
- B - 4 meter fabric cord fitted with ceiling loop and connector block
- C - Two-part ceiling cup

Please read these instructions carefully and retain them for future reference to ensure that the lamp is used correctly. For your own safety, please study each step of this instruction manual first. &tradition is not responsible for any faults or damages caused by not following these instructions correctly. Do not modify this lamp in any way.

TOOLS NEEDED

- Small flat-head screwdriver for wiring
- Cable cutters
- Cable stripper
- Bulb type: E27 fitting 100 watt tungsten bulb or 23 watt low energy bulb

SAFETY PRECAUTIONS

- Dispose of the bag from packaging and do not allow children to play with it.
- Keep product well out of children's reach.
- The lamp is only intended for interior use.
- Do not attempt installation of product if you are not competent to do so yourself.
- Consult a professionally qualified electrician if in any doubt.
- Disconnect the electricity supply at the fuse box, before comencing work.

CLEANING INSTRUCTIONS

- Wipe surface of the lamp shade with a soft dry cloth.
- Do not use any abrasive cleaning tools such as steel wool, scouring sponges or stiff brushes.
- Never use strong cleaning agents such as white spirit, turpentine, household glass cleaner or cellulose thinners.

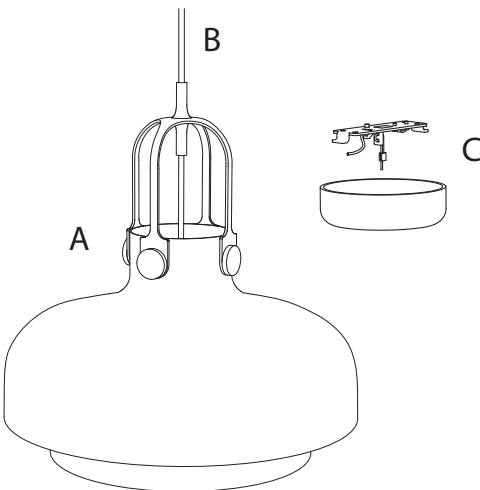

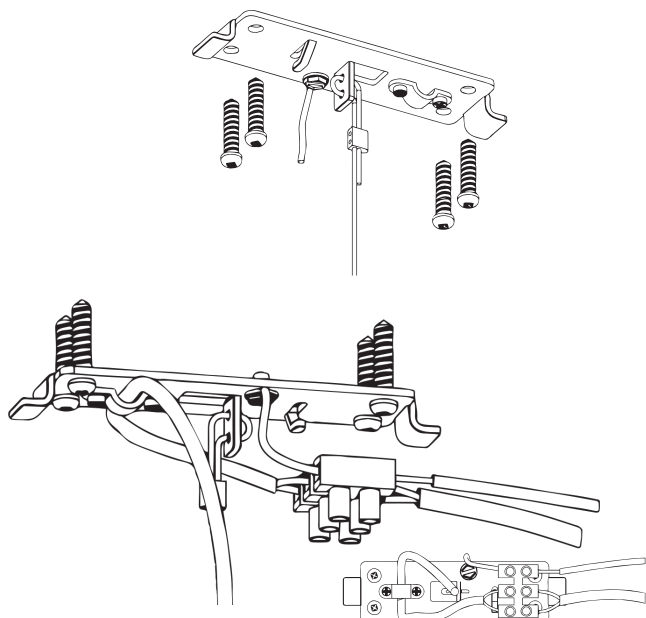

STEP 1

Ensure power supply is turned OFF and remove any existing lamp fitting. Locate the supply cable and ensure it is ready to be fitted to the connector block. Mount the metal plate securely in the ceiling with screws and appropriate wallplugs for the type of ceiling of the installation.

STEP 2

To determine the correct hanging height for the lamp, pass the safety steel wire through the metal plate bracket, define the desired height and make sure the steel cable is blocked with two screws. The safety steel wire shall always be shorter than the electrical cable during and after installation. The excess wires can be cut after assuring the suspension wire is blocked.

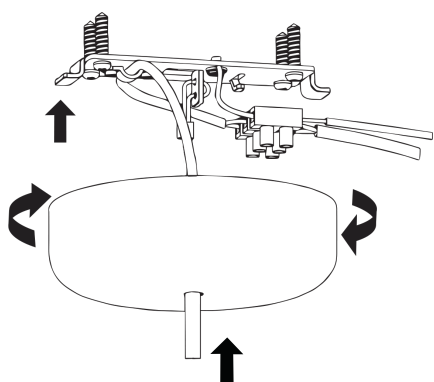

STEP 3

Connecting the wires:
Cut off the excess cord using a cable cutter so that minimum of 80 mm cord is left to reconnect to the cable connector. Peel back the outer cable using a cable stripper to expose 30 mm of the blue and brown inner cables. Strip the inner cable to expose 5 mm of wire. Connect the blue supply wire to the blue fixture wire. Connect the brown supply wire to the brown fixture wire. Connect the green supply wire to the green fixture wire. Install the plastic canopy onto the metal plate.

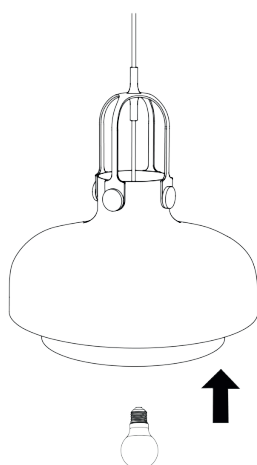

STEP 4

Screw in the light bulb.

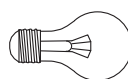

Maximum 100 W.
E26 socket



Maximum 23 W.
Low Energy E26

CE □ ▽ F IP20

tradition®